



10355





[LEGO.com/sustainable-packaging](https://www.lego.com/sustainable-packaging)



 **FR**
DONNEZ
OU
RECYCLEZ

 OU  OU 

ASSOCIATION MAGASIN DÉCHÈTERIE

Adresses sur quefairedemesdechets.fr



BUILDER



Apple and the Apple logo are trademarks of Apple Inc., registered in the U.S. and other countries and regions. App Store is a service mark of Apple Inc. Google Play and the Google Play logo are trademarks of Google LLC. Tencent and the Tencent logo are trademarks of Tencent Inc.

Q LEGO.com/devicecheck



Q LEGO® Builder

Die Rückkehr von LEGO® Blacktron

Wenn wir uns in die Blütezeit der LEGO® Raumfahrt-Themenwelt in den späten 1970er- und 1980er-Jahren zurückversetzen, scheint die Blacktron *Renegade* (6954) immer irgendwie über uns zu schweben. Seit ihrer Markteinführung im Jahr 1987 ist sie eines der absoluten Lieblingsmodelle der LEGO Weltraumfans geblieben. Ihre Beliebtheit verdankt sie unter anderem der Tatsache, dass sie die Fantasie der Baumeister weckt. Außerdem können sich die Fans eigene außergewöhnliche Geschichten über diese ersten geheimnisvollen Blacktron-Bösewichte im Universum der LEGO Weltraum-Sets ausdenken. Wer sind sie? Wo kommen sie her? Und was wollen sie hier? Die Farbgebung in Schwarz und Gelb betonte den „bösen“ Look der Uniformen und Schiffe. Und durchsichtig-gelbe Windschutzscheiben sowie durchsichtig-rote Akzente verliehen den supercoolen Modellen dieser Serie ein einheitliches Design. Die äußerst vielseitige Bauart ließ die Baumeister besonders kreative Modelle zum Spielen und Ausstellen erschaffen. Alle Sets bestanden aus Modulen, um mehrere Modelle miteinander kombinieren oder zerteilen und völlig neu zusammensetzen zu können. Zu jener Zeit war diese Idee ein absolut bahnbrechendes LEGO Designkonzept, das uns zu neuen Generationen von Weltraummodellen inspirieren sollte.



BLACKTRON™



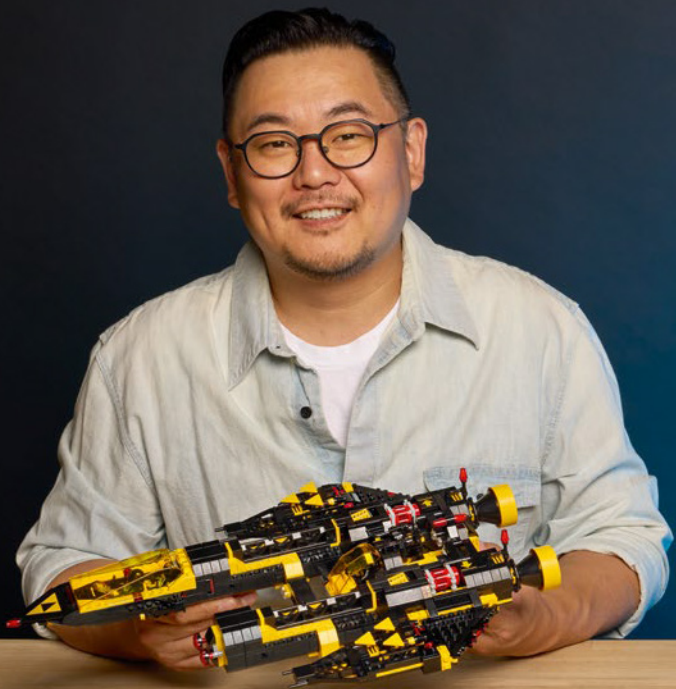

Anmerkungen des LEGO® Designteam

„Wir sind hellauf begeistert, die Blacktron *Renegade* (6954) zusammen mit Elementen aus den Sets *Invader* (6894) und *Battrax* (6941) für Fans jeden Alters wieder aufleben zu lassen. Wir haben das klassische asymmetrische Design der *Renegade* beibehalten, allerdings ist die neue Version eineinhalb Mal so groß. So war es uns möglich, das Modell mit moderneren Details, cooleren Funktionen und spannenderen Bautechniken aufzupeppen. Das Cockpit haben wir so gestaltet, dass 2 Piloten hineinpassen. Außerdem haben wir eine neue Absetzfunktion und einen kleinen Lasten-Rover gebaut, der direkt vom Schiff aus abgesetzt werden kann. Die kleinen Raumschiffe an beiden Seiten der Originalflügel wurden als eine neue Art von Weltraum-Scooter mit einem neuen Droiden in klassischer Optik wiedergeboren. Alle Module des Schiffs können separat gebaut und mithilfe des neuen Universalverbindungsstücks entweder vorne oder hinten montiert werden. Schlüpf also in deinen Raumanzug, mach dich startklar und lade deine Freunde und deine Familie ein, dieses faszinierende Bauerlebnis mit dir zu teilen!“

JAE WON LEE

LEGO® Senior Designer



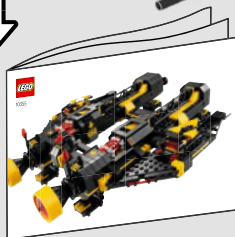
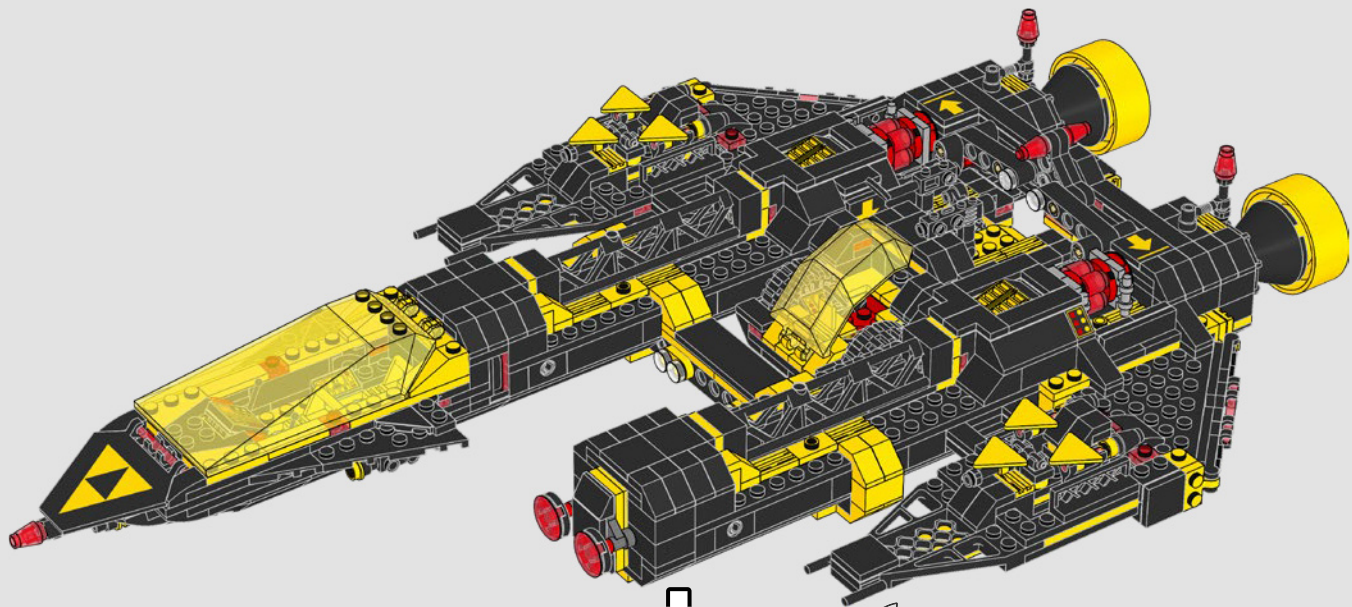

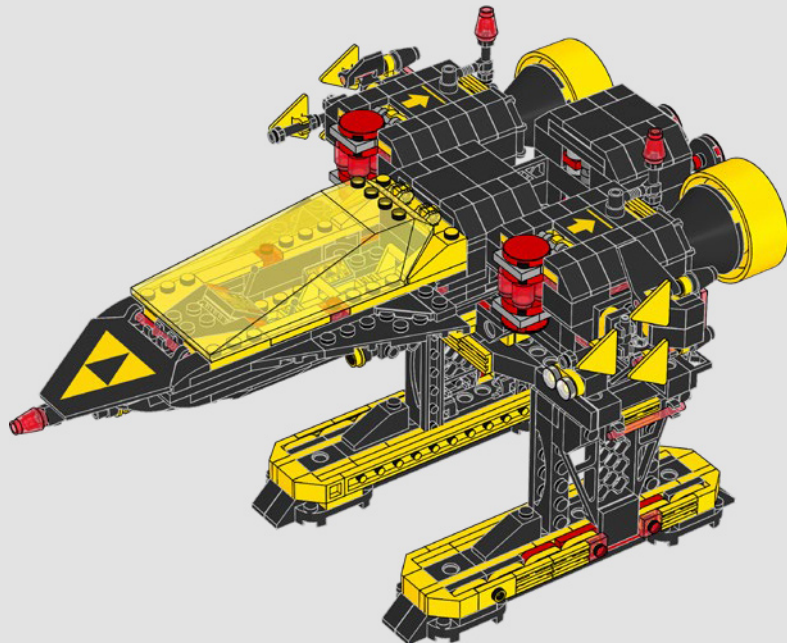

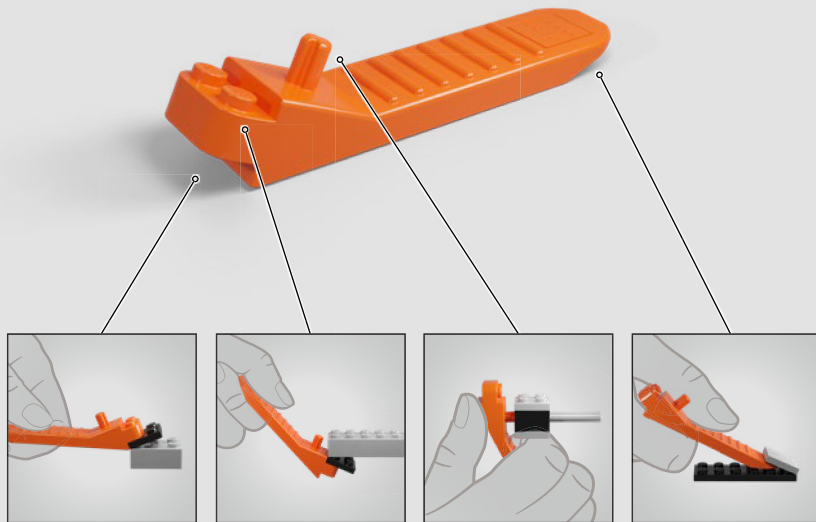



Bei näherer Betrachtung des Blacktron-Raumanzugs wirst du ein moderneres Gerät am Rücken entdecken, das man bei der ersten Begegnung mit dem Blacktron-Raumschiff (40580) erstmals zu sehen bekam.

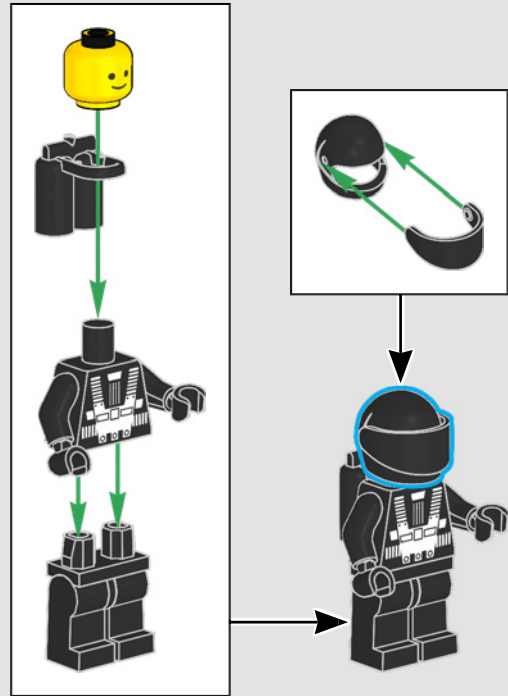



1

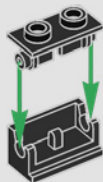

1x

2

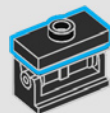

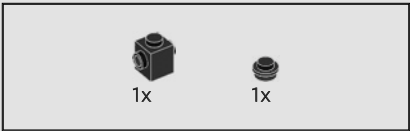

3

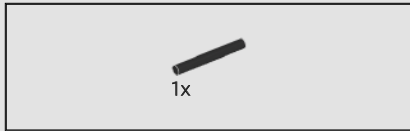
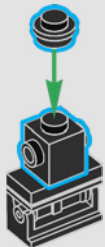

4

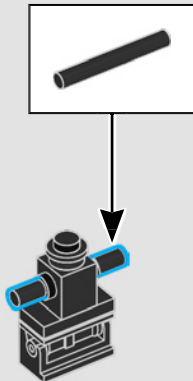



5

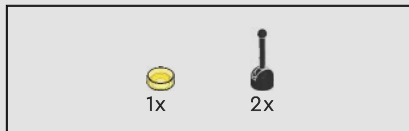
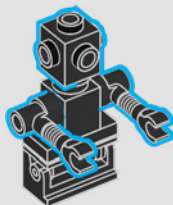

6

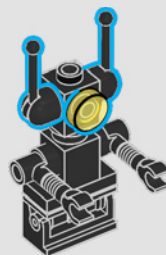

Dieser Roboter scheint eine von Blacktron manipulierte Version des standardmäßigen Roboterassistenten zu sein, der zusammen mit dem Solar Power Transporter (6952) herausgebracht wurde.



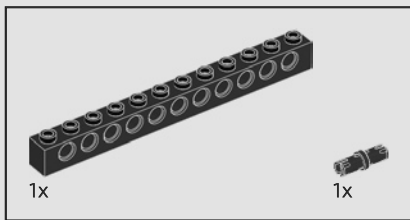
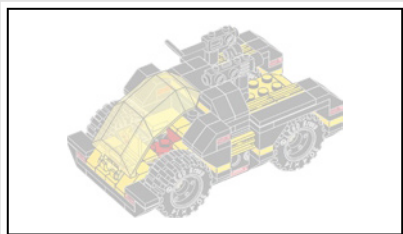

1

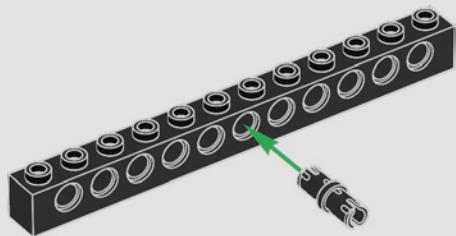

2

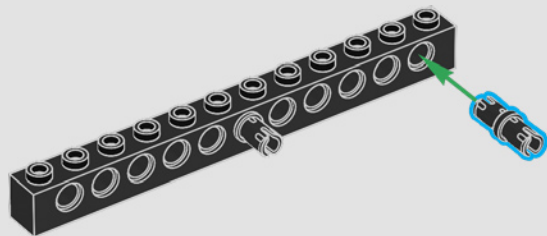



3

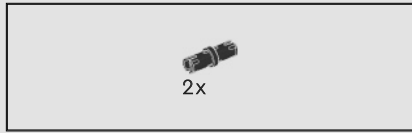
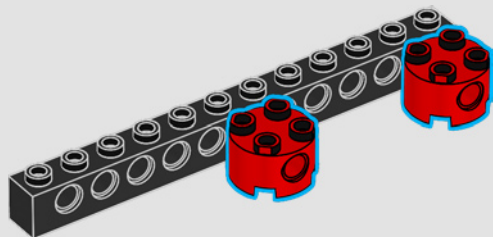

4

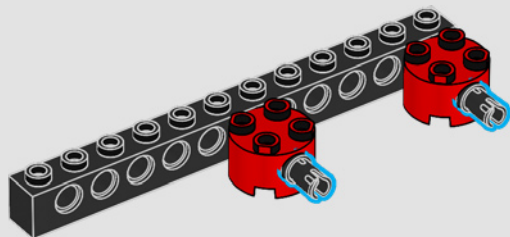

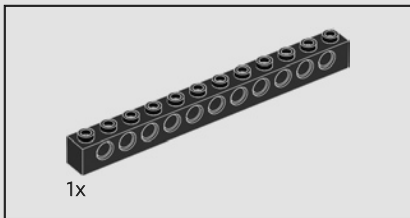

5

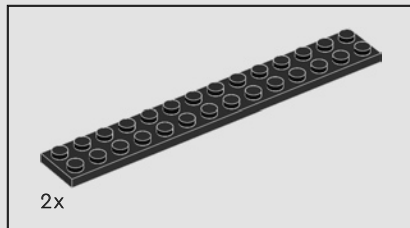
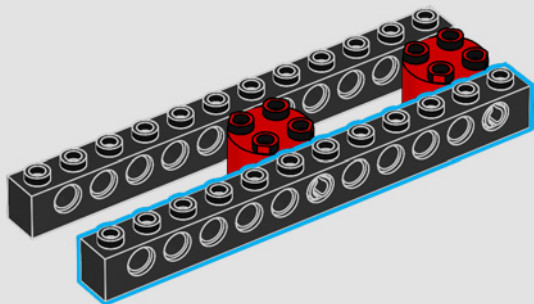

6

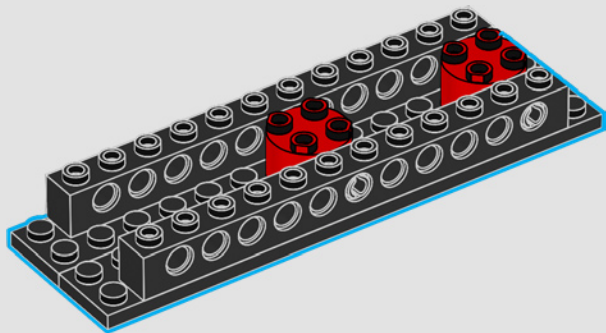

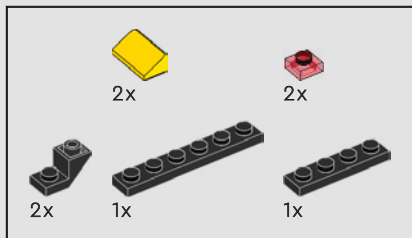

7

1

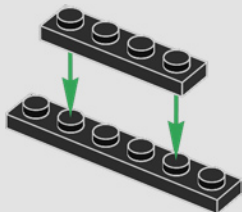

2

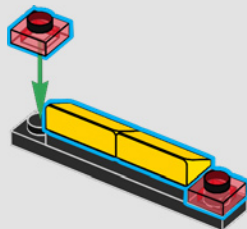

3

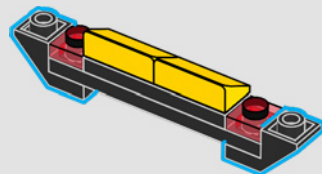

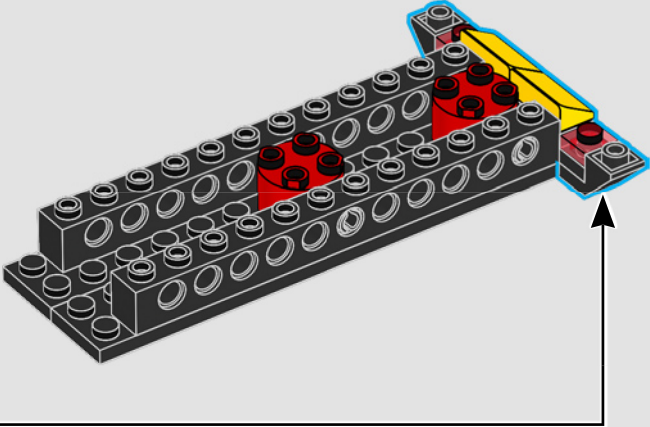

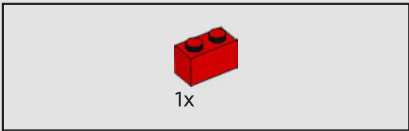

8

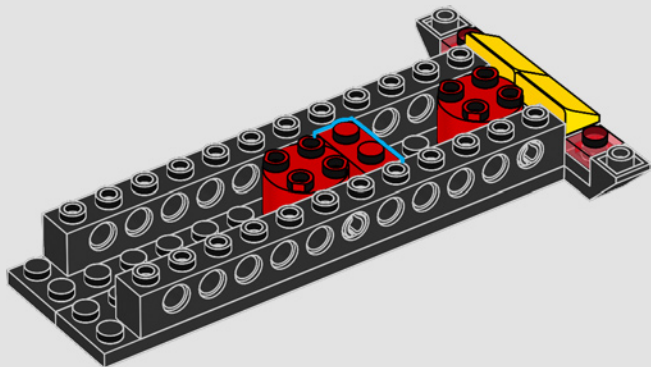

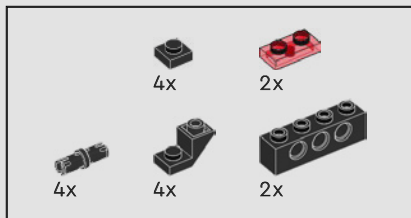

9

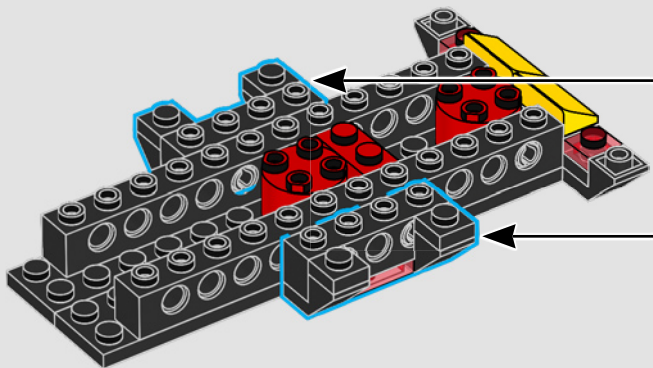
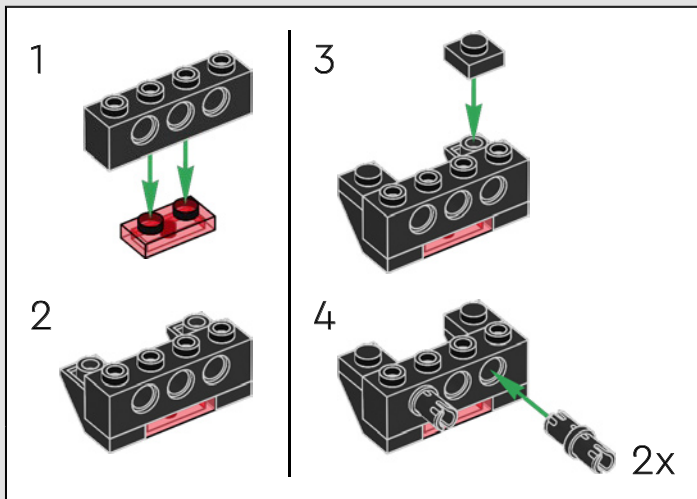

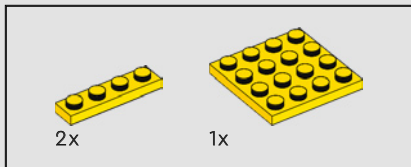

10

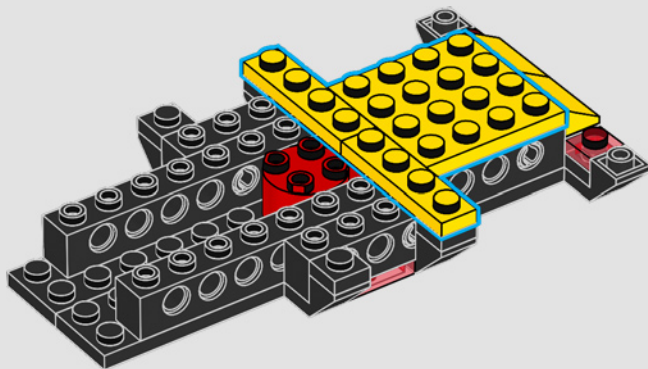

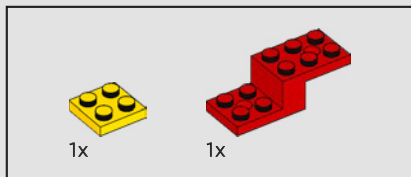

11

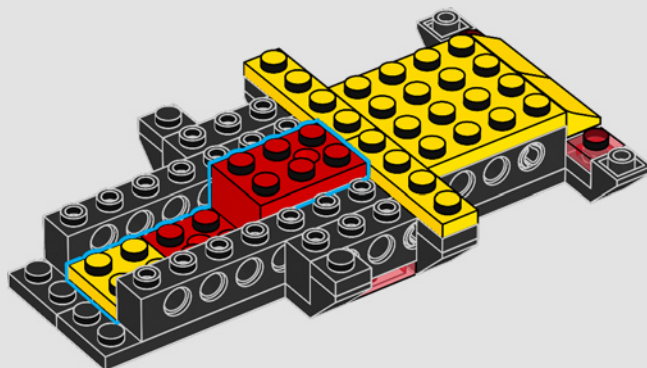

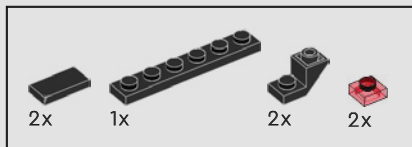

12

1

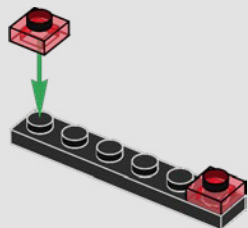

2

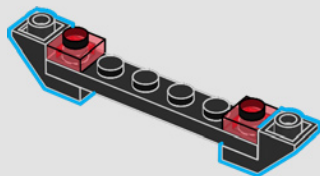

3

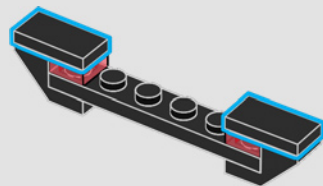

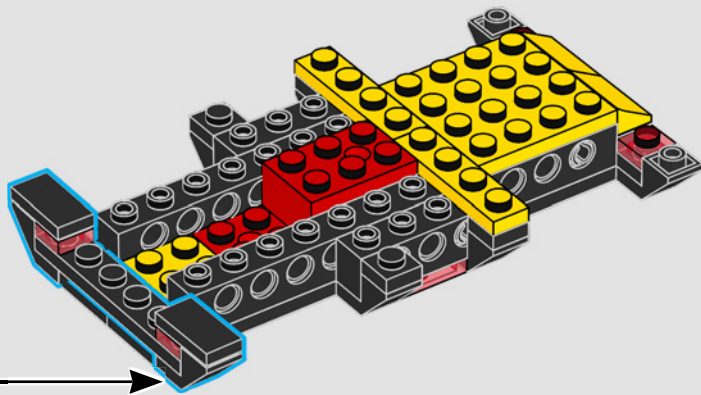

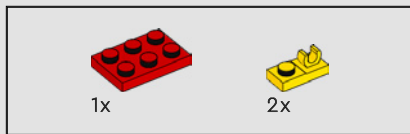

13

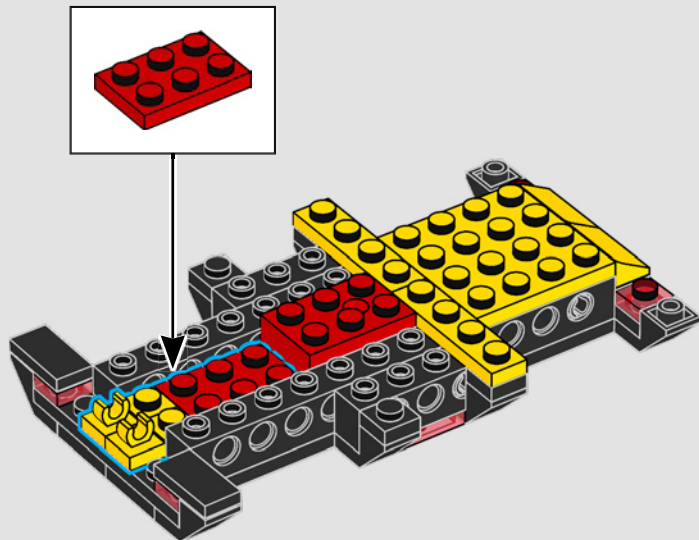

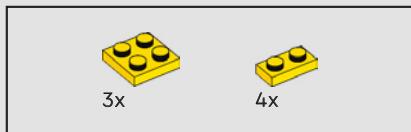

14

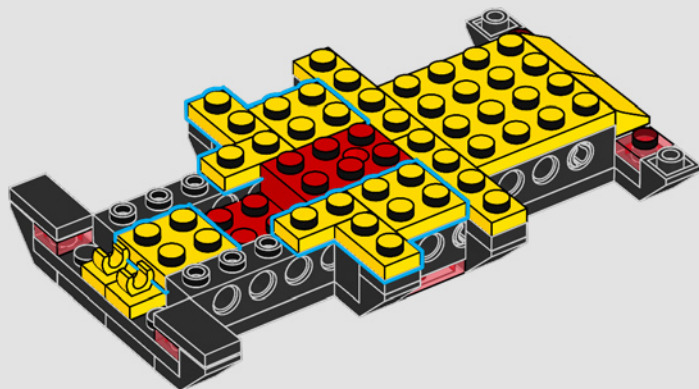

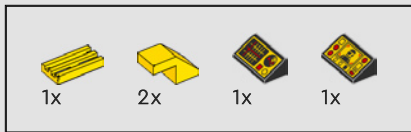

15

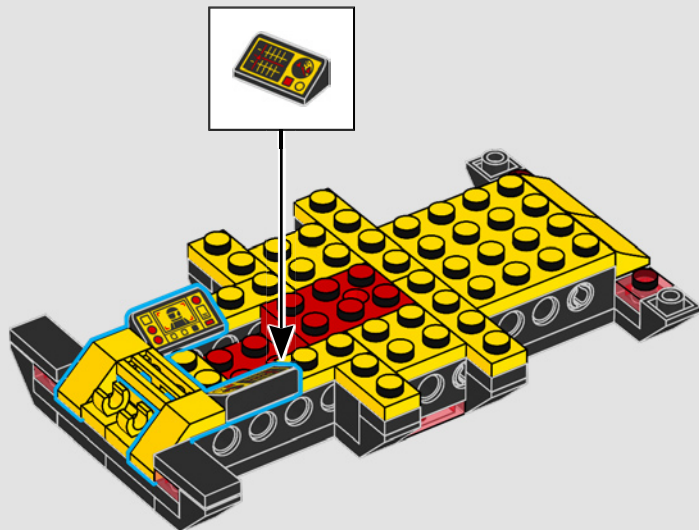

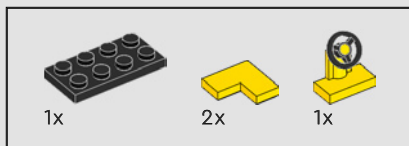

16

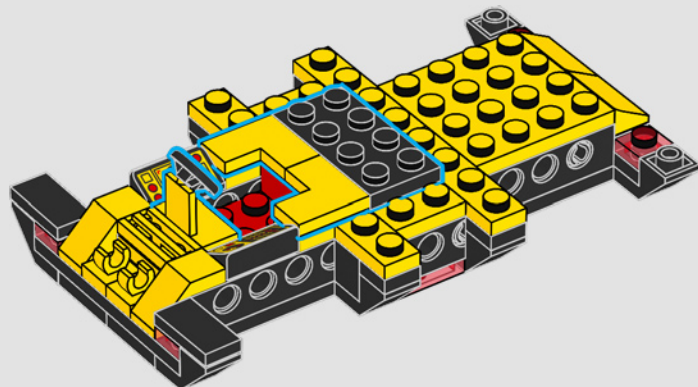

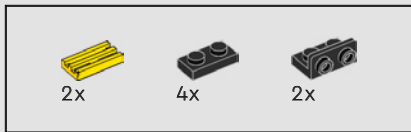

17

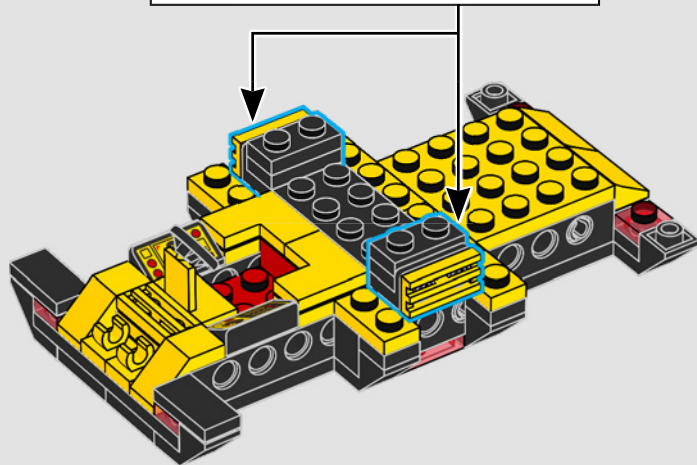
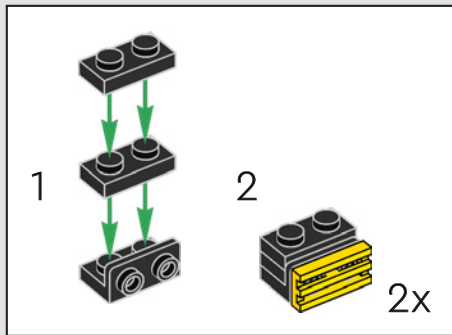



4x

18

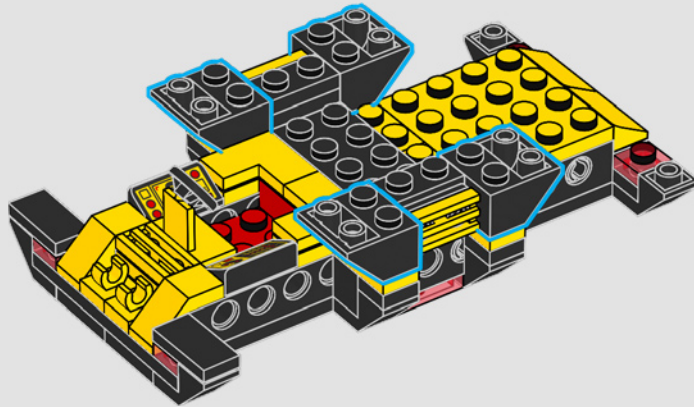

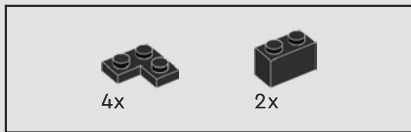

19

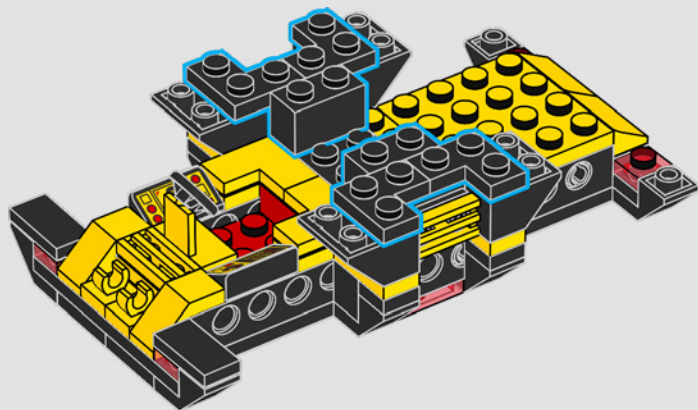

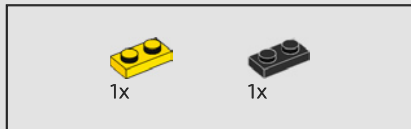
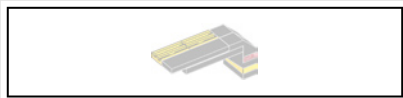

20

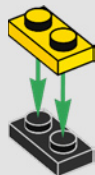

21

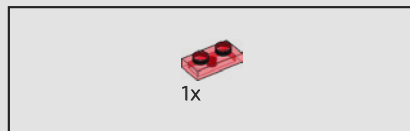
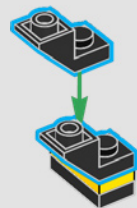

22

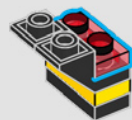

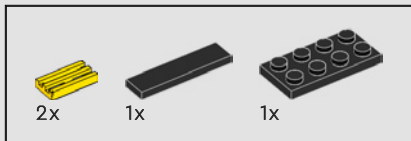

23

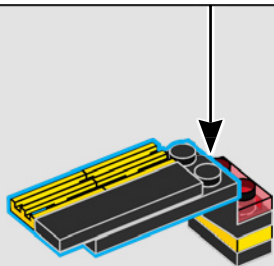
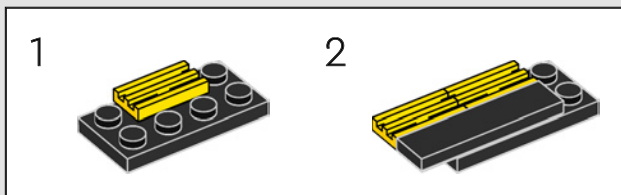

24

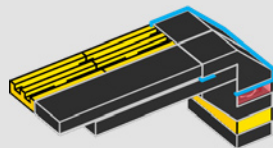

25

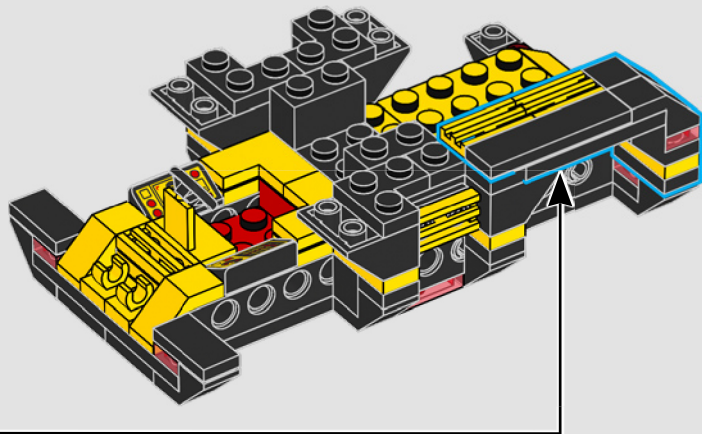

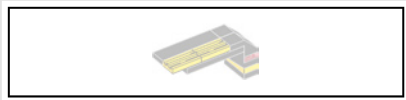

26

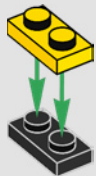

27

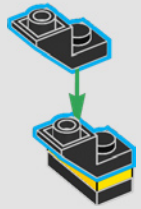



28

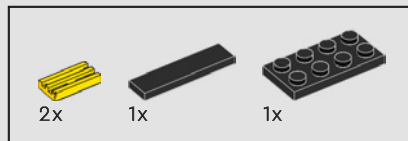
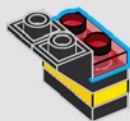

29

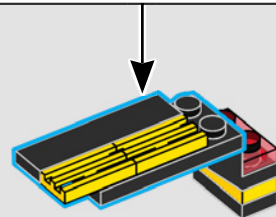
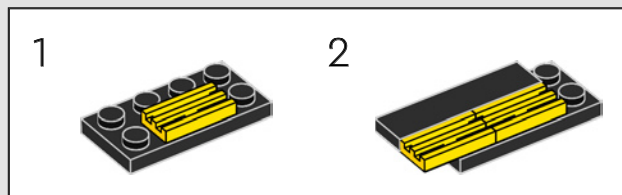



2x

30

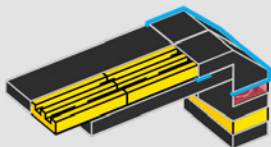

31

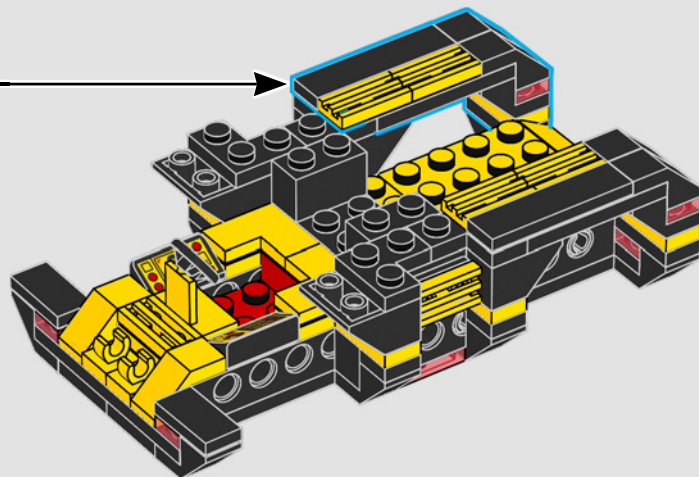

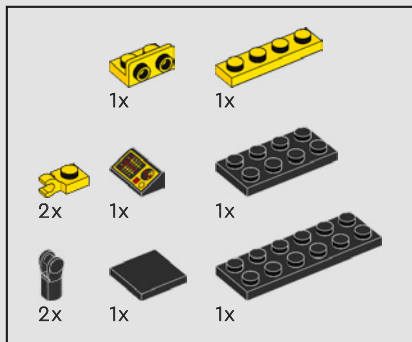

32

1

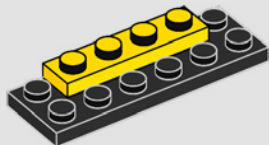

2

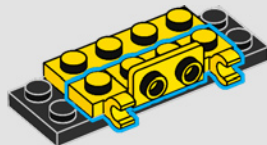

3

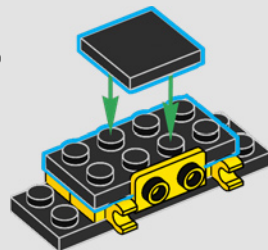

4

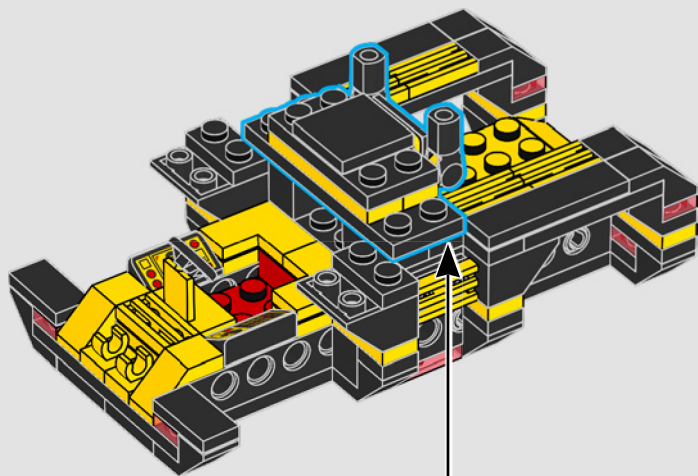
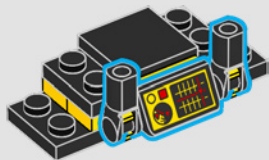



2x

33

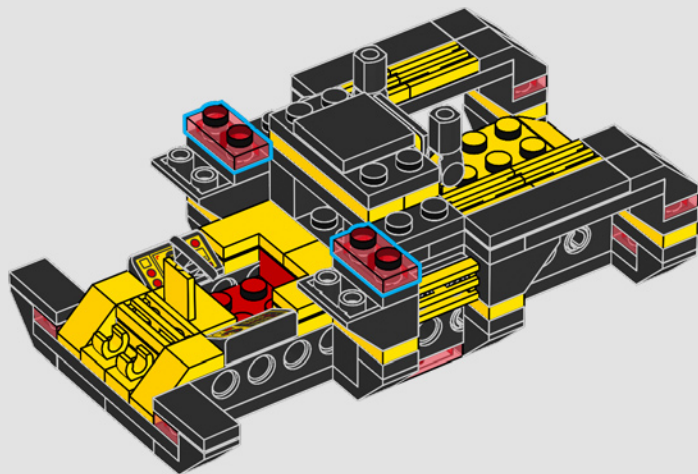



8x

34

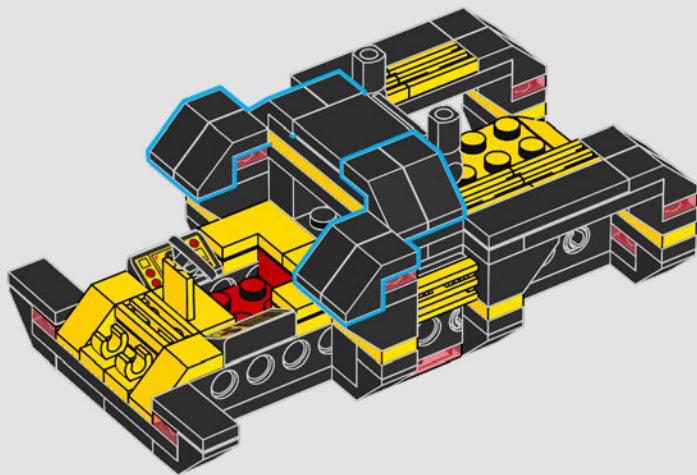

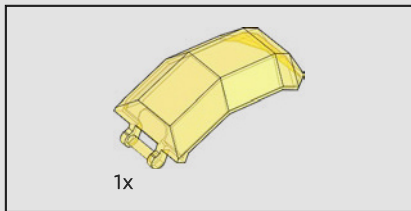

35

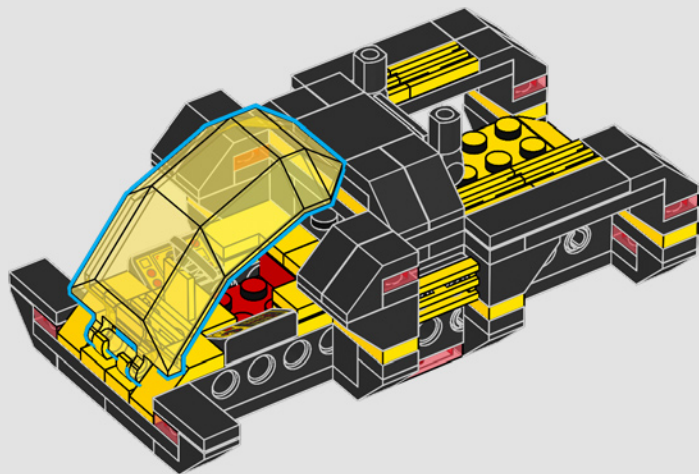



Die Blacktron-Ingenieure haben die Optik der standardmäßigen Weltraumforschungskamera umgedreht und in einen Laserblaster verwandelt.

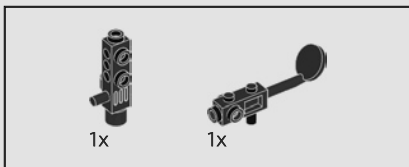

36

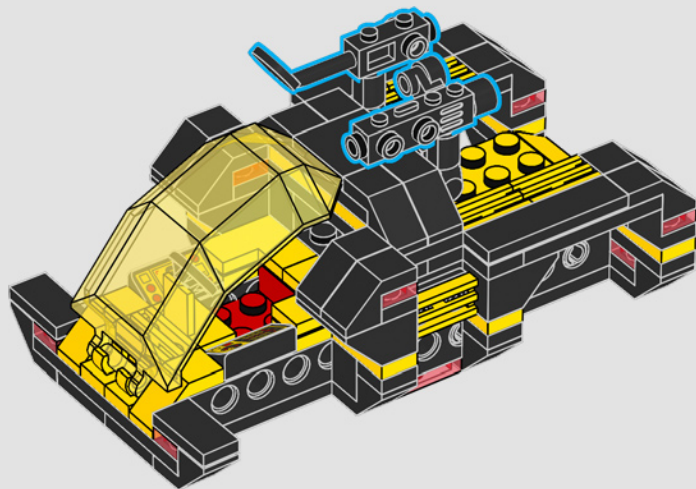

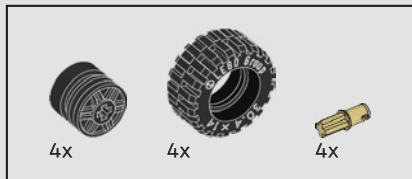

37

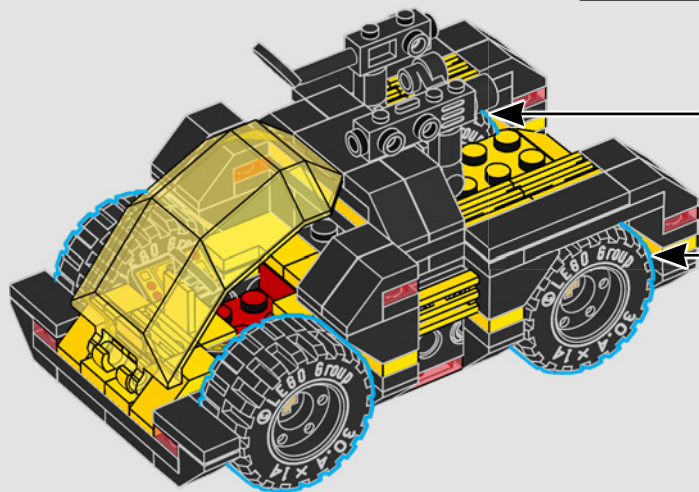
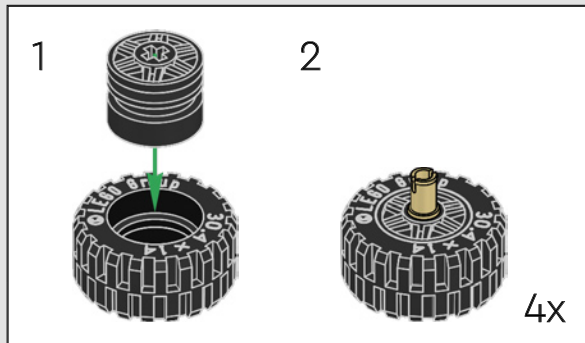

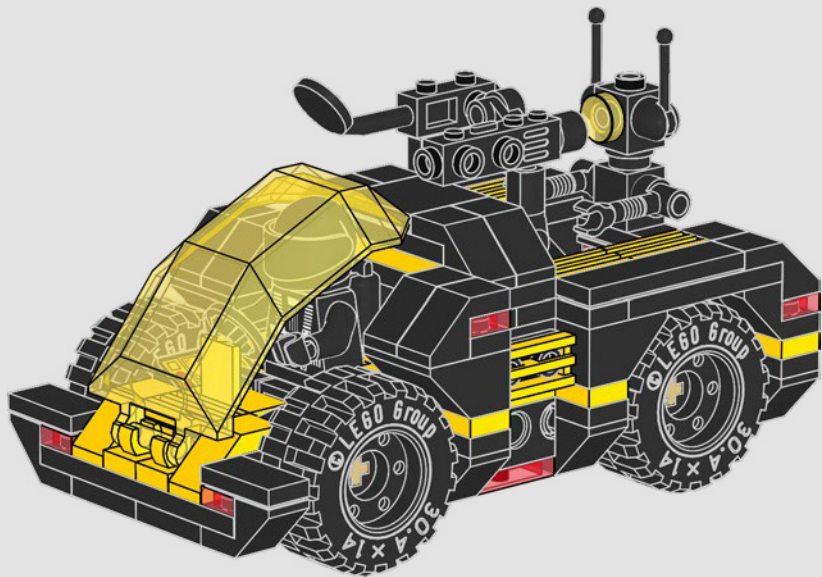

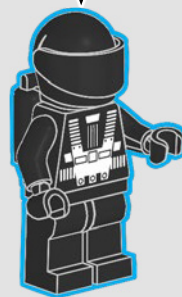
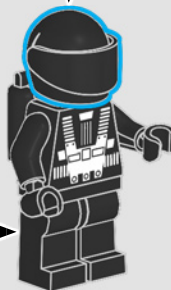
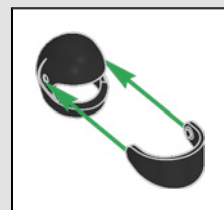
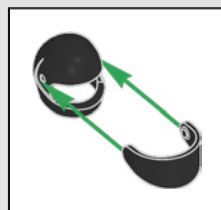
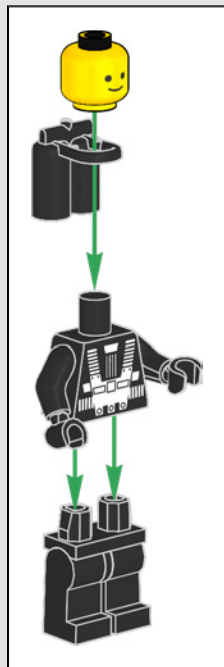

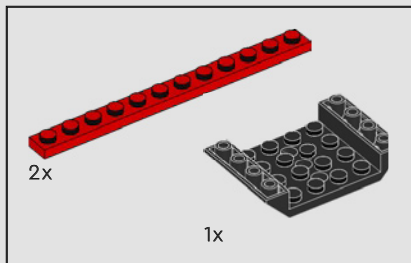
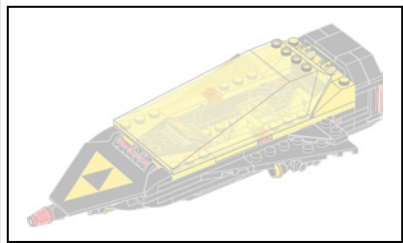

1

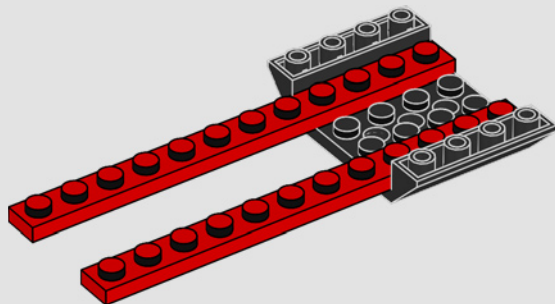

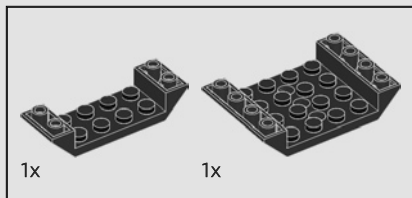

2

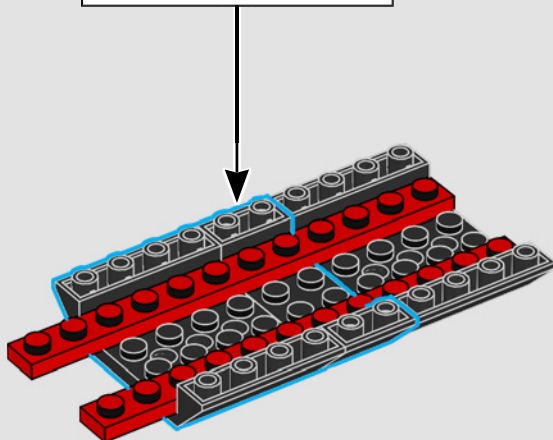
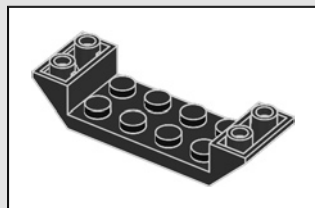

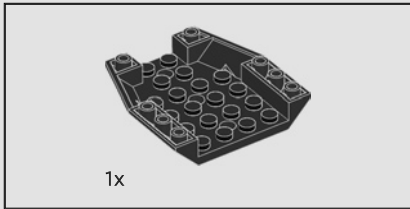

3

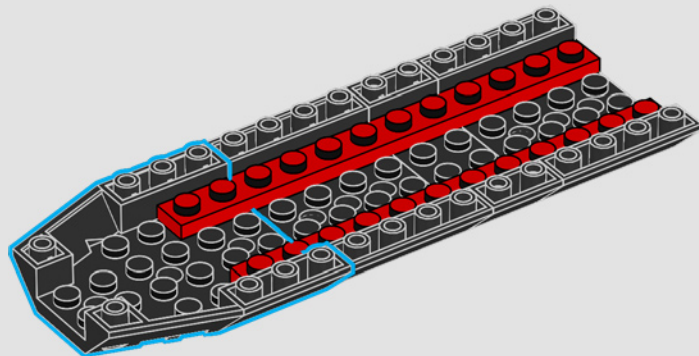

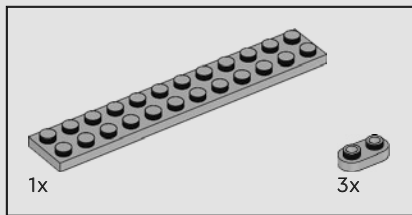

4

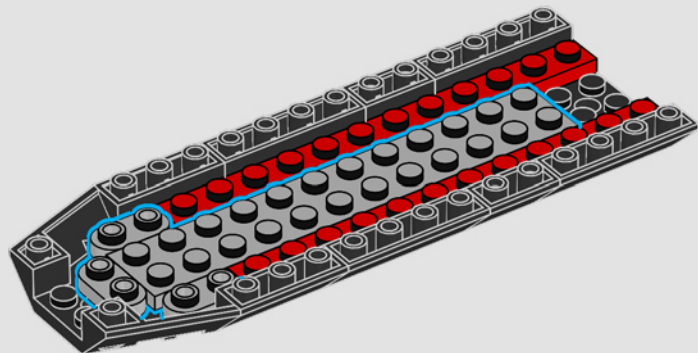

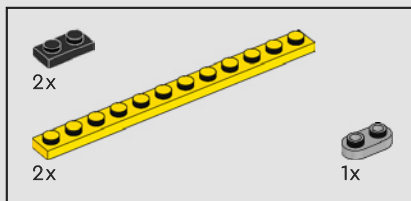

5

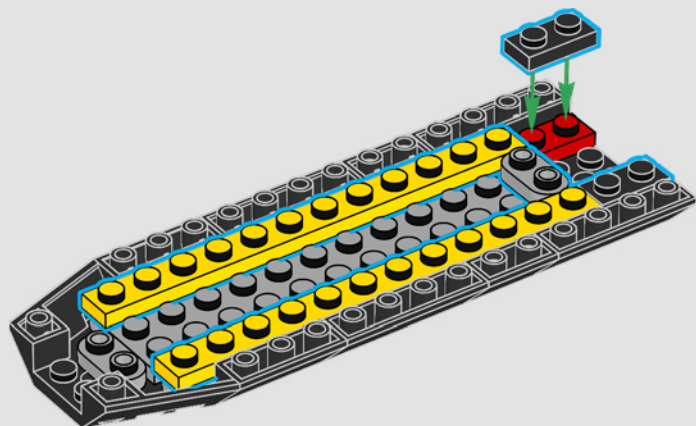

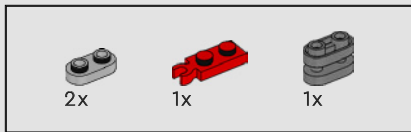

6

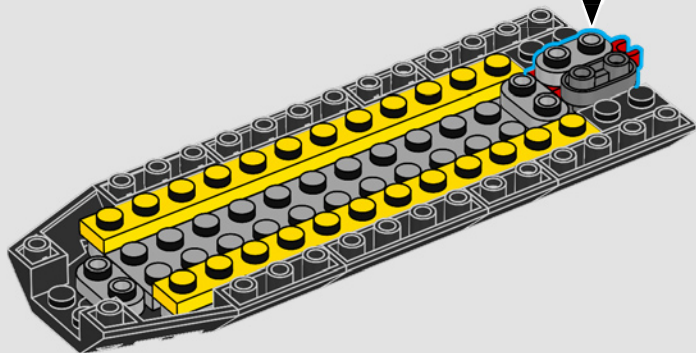
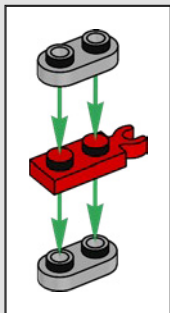

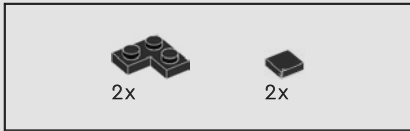

7

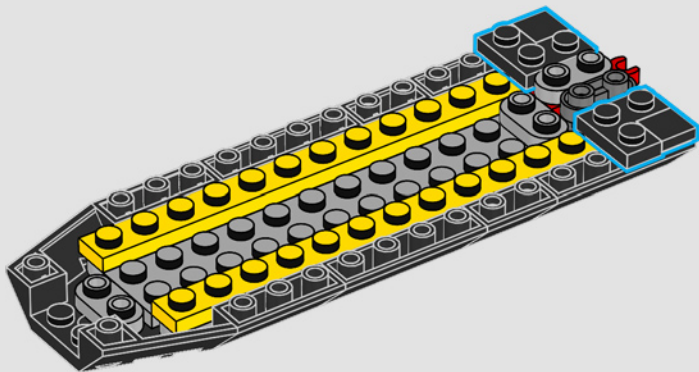

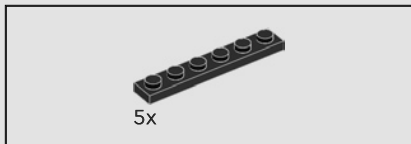

8

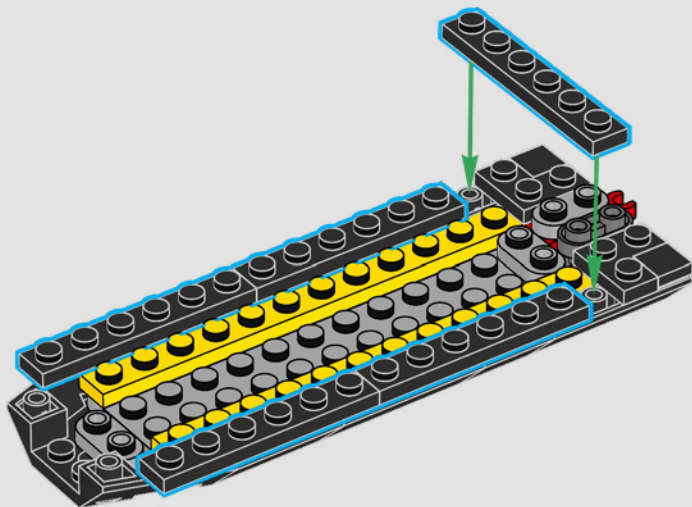

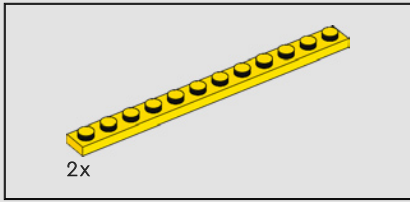

9

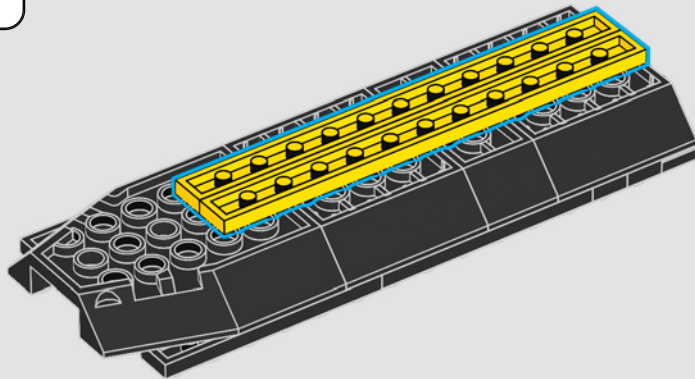

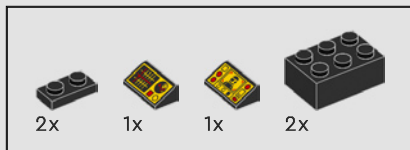

10

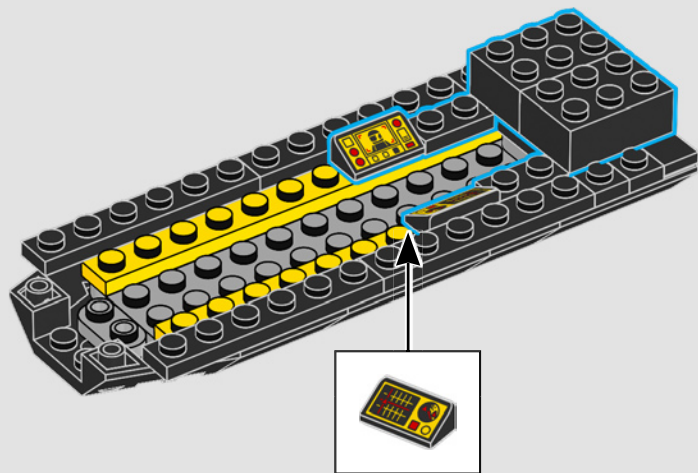



In dieses modernisierte Raumschiff passen zwei Piloten.
Doppelt so viele Blacktron-Agenten bedeuten auch
doppelte Gefahr für die Galaxie!

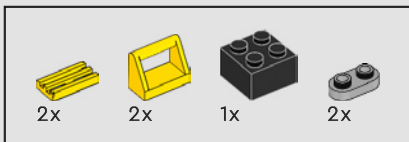

11

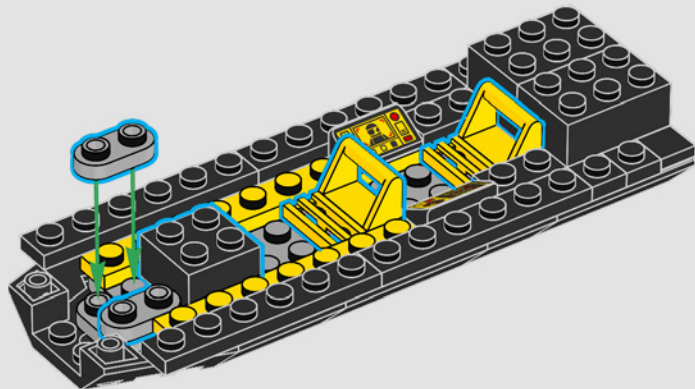



12

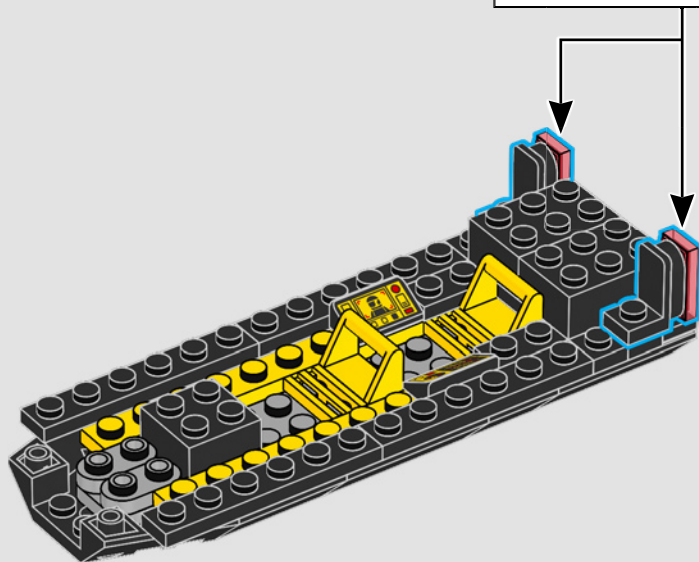
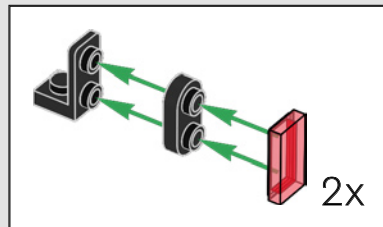

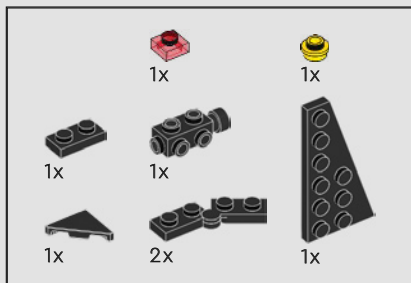
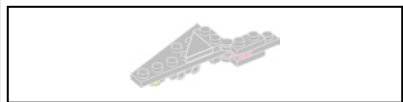

13

1

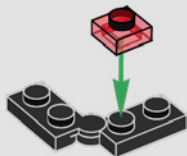

2

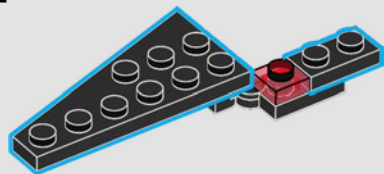

3

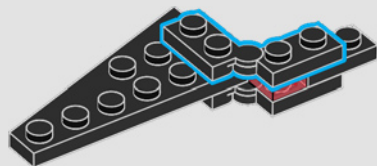

4

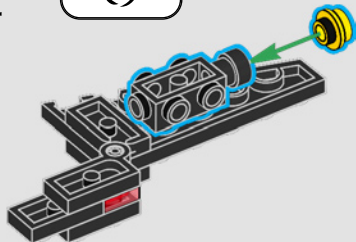
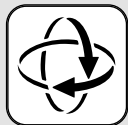

5

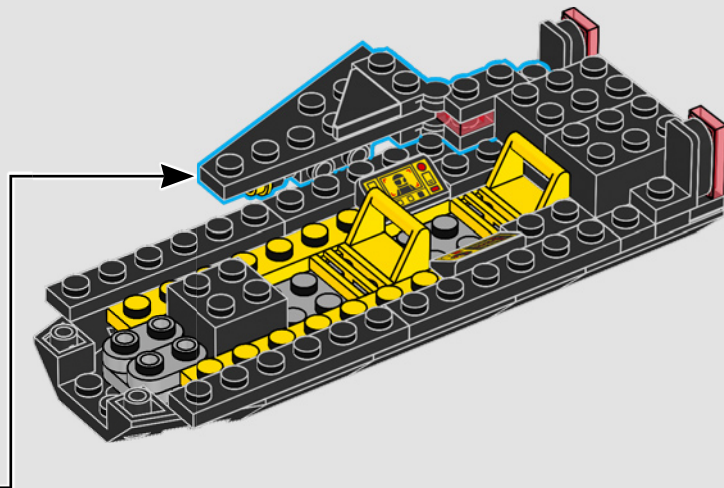
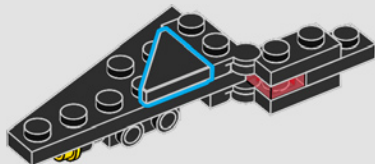

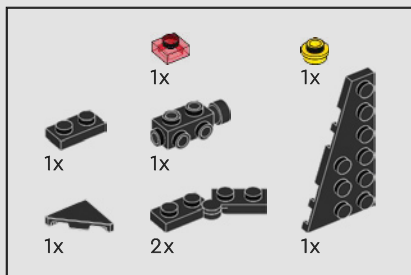
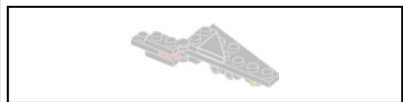

14

1

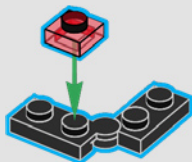

2

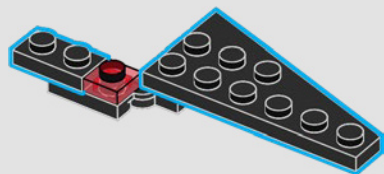

3

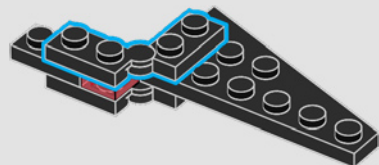

4

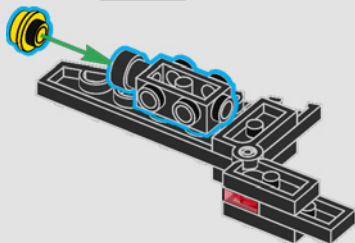

5

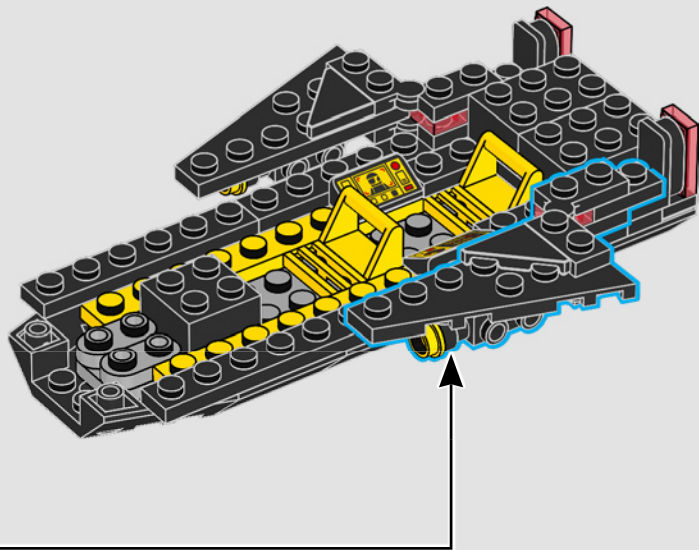
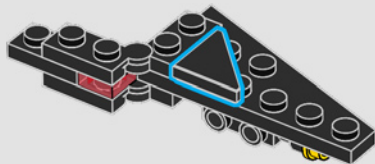

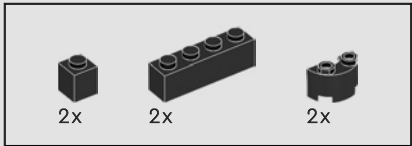

15

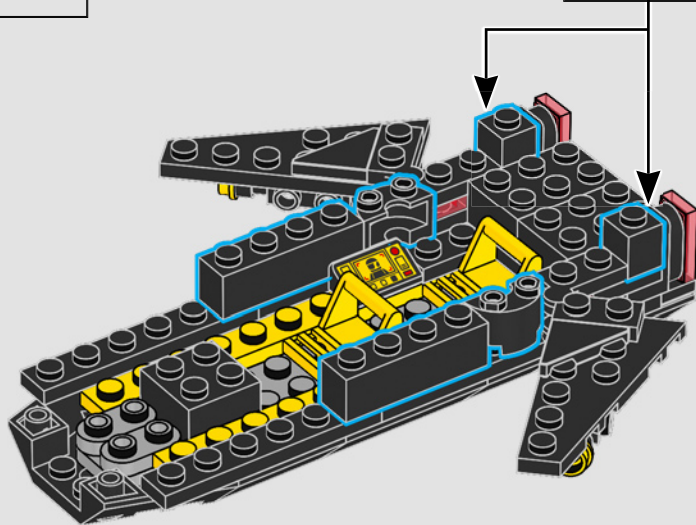

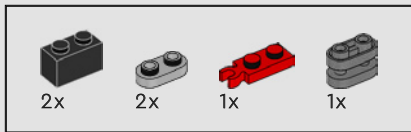

16

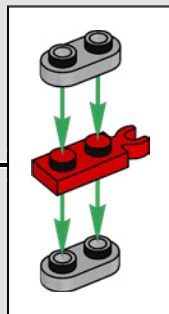
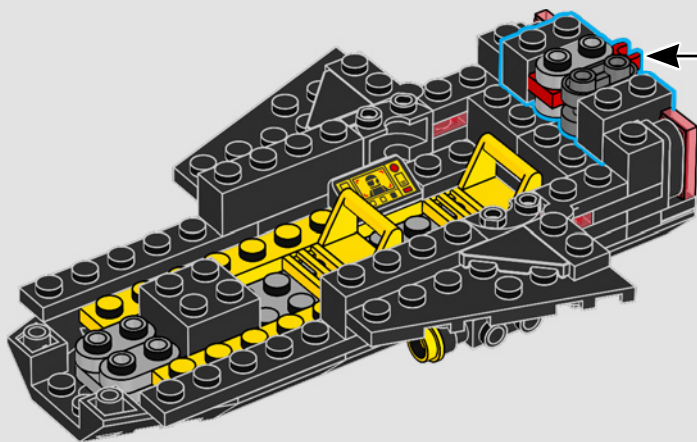

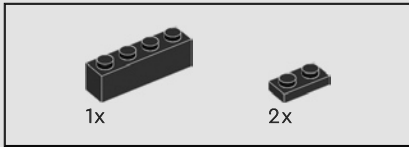

17

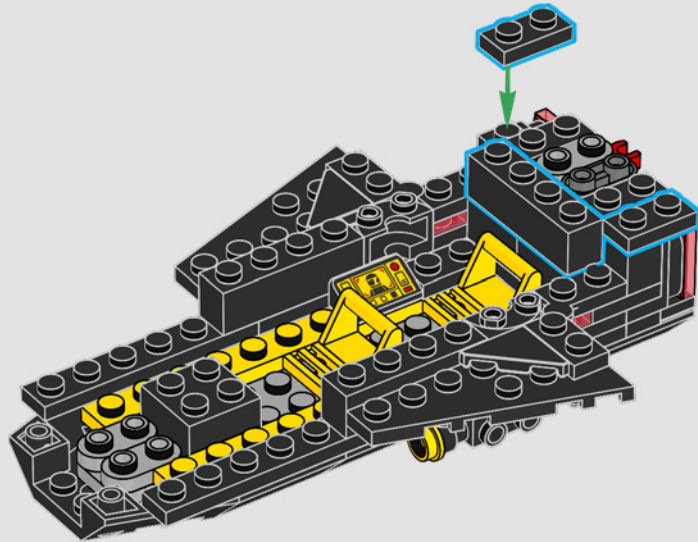

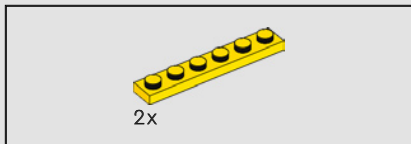

18

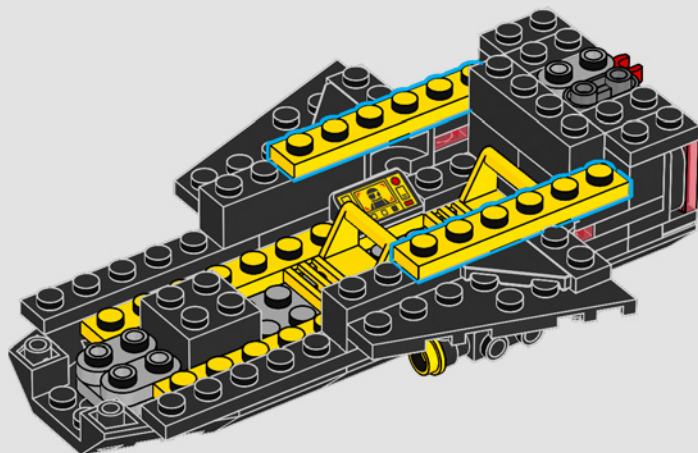

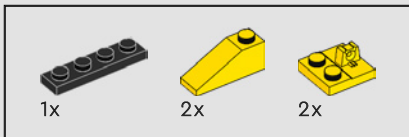

19

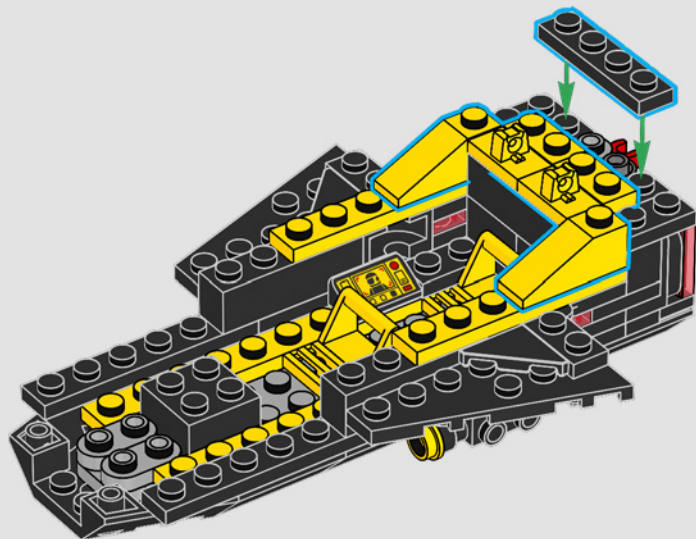

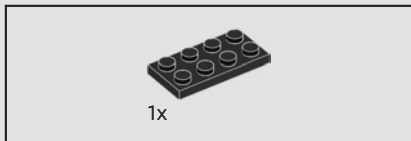

20

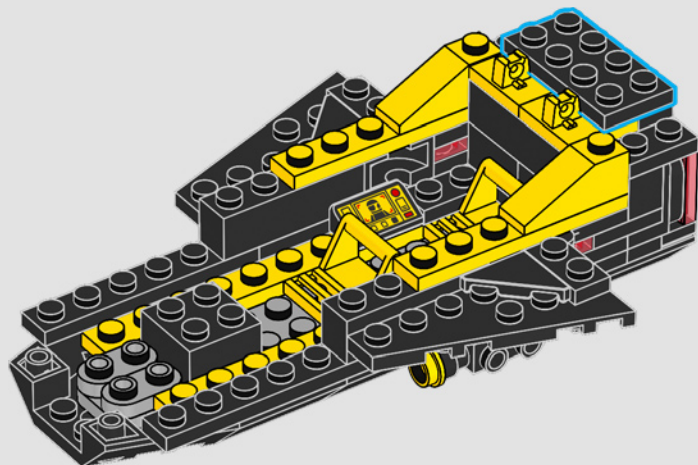

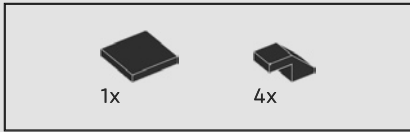

21

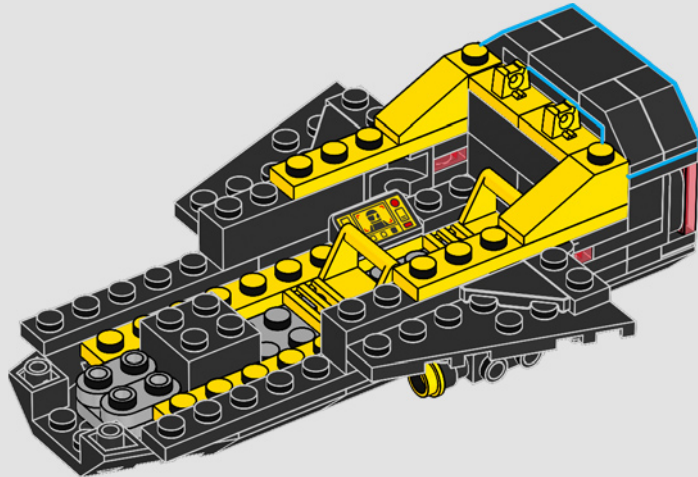

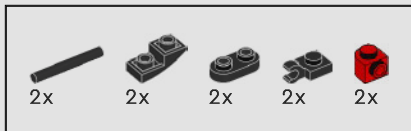

22

1

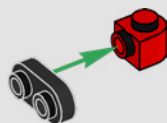

2



3

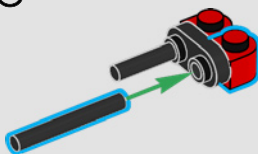

4

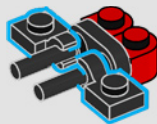

5

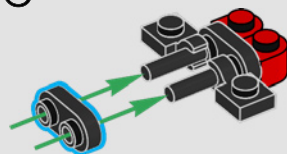

6

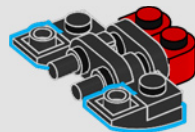

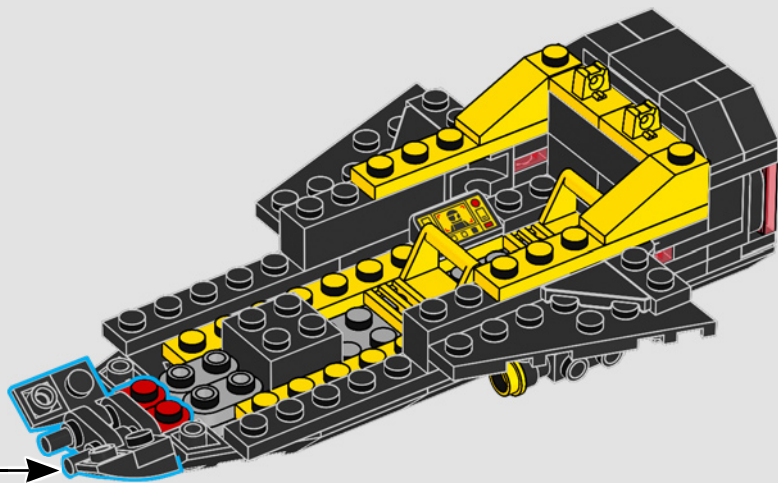

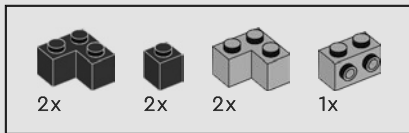

23

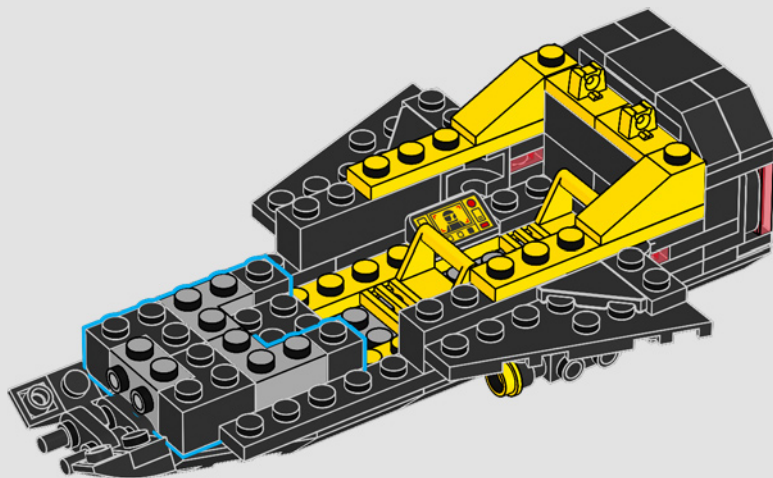

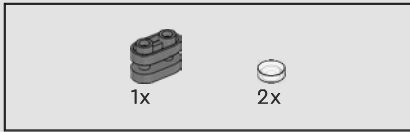

24

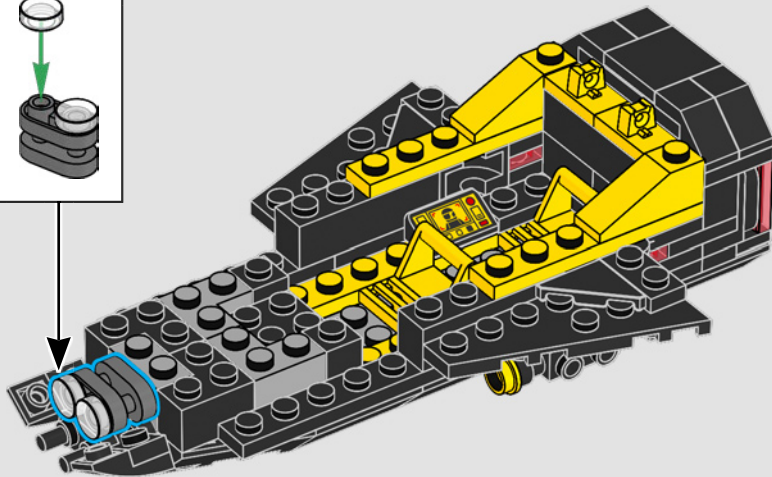
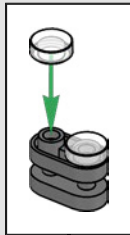



25

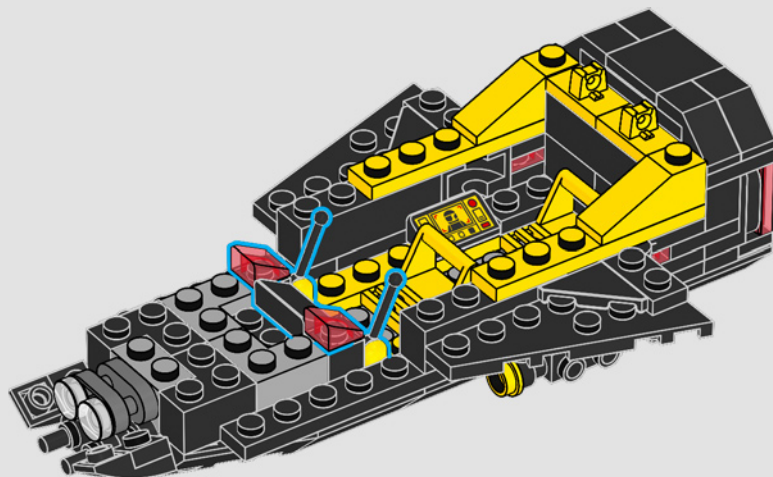



26

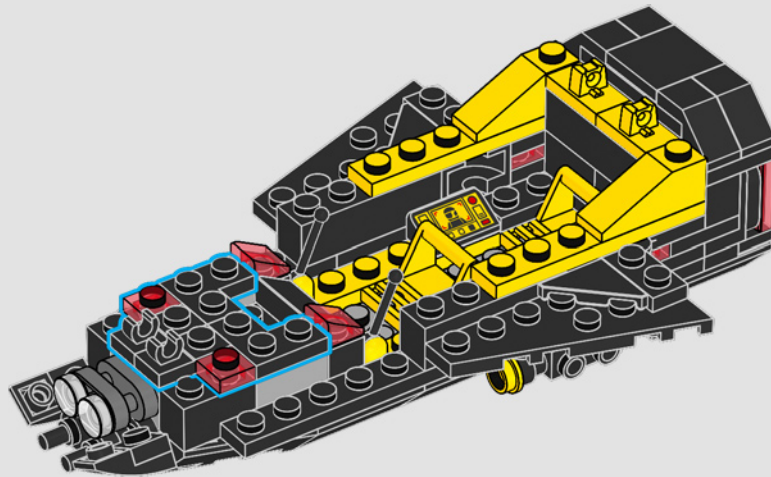

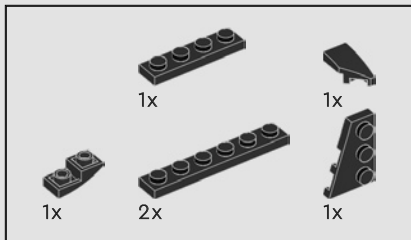

27

1

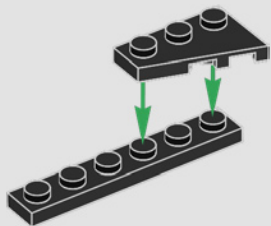

2

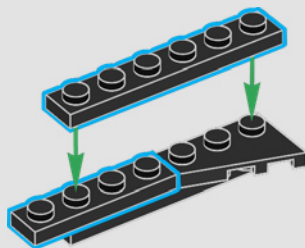

3

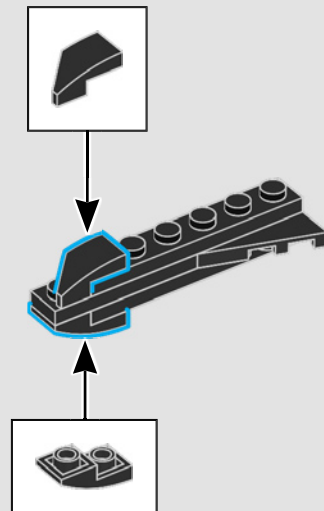

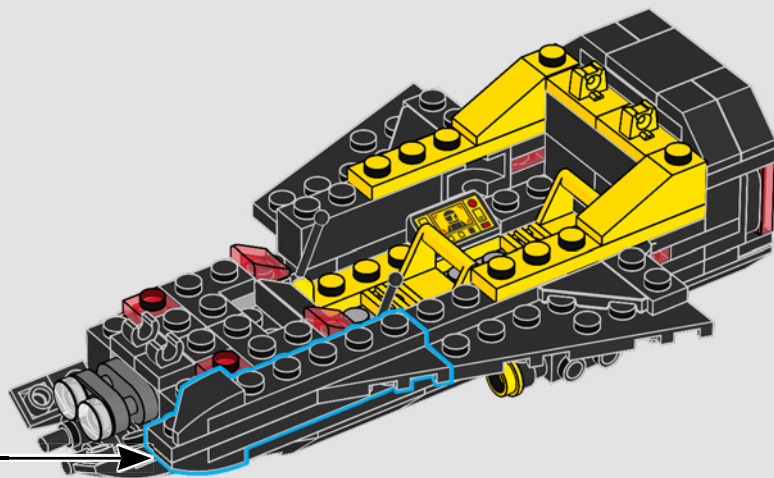

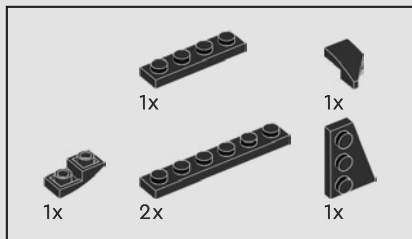

28

1

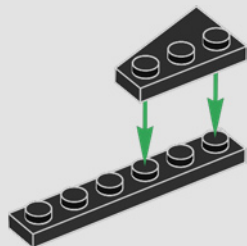

2

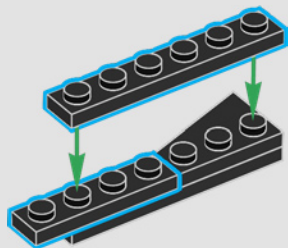

3

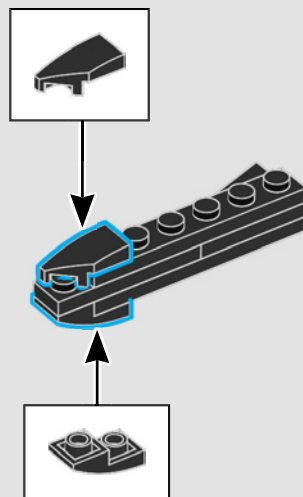

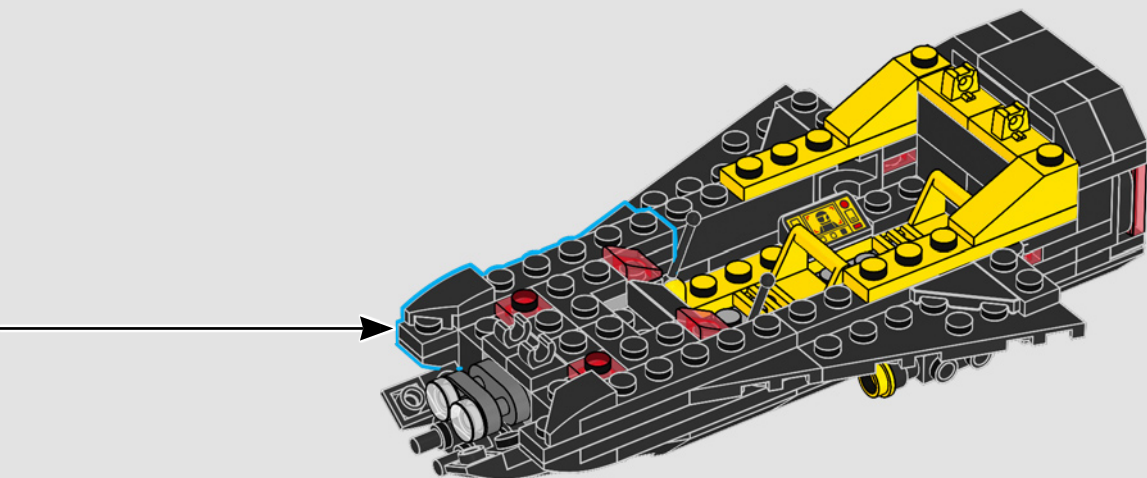

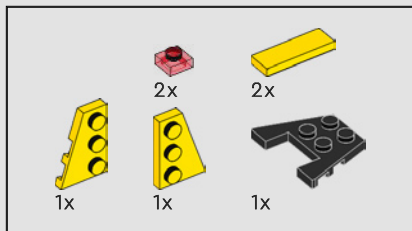

29

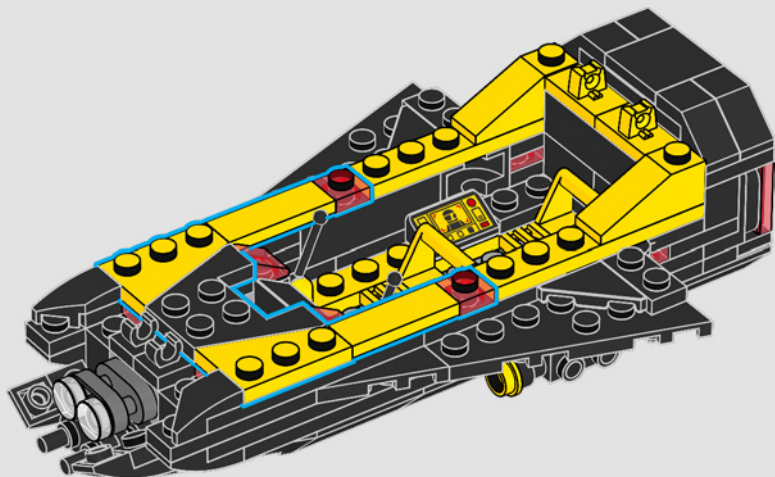



30

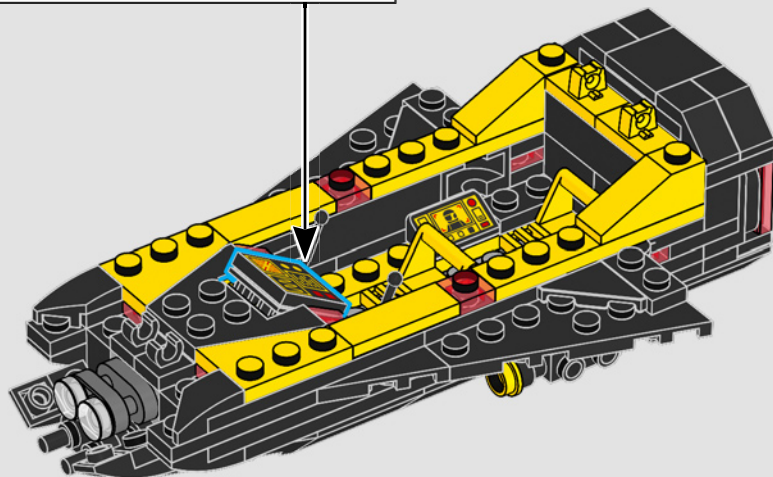
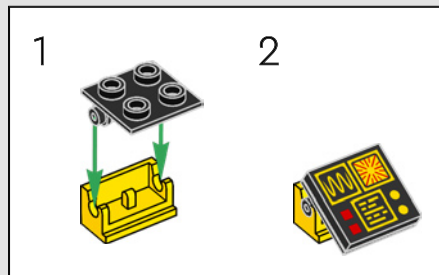



31

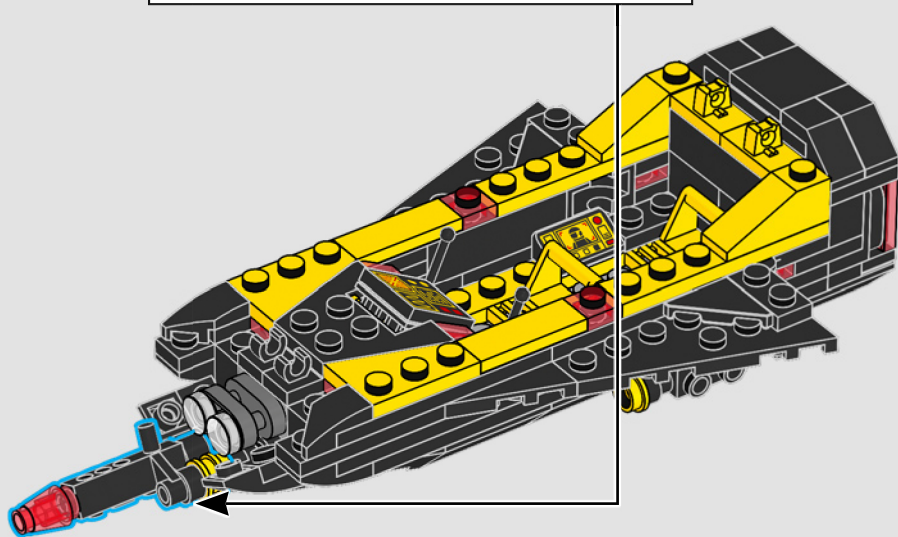
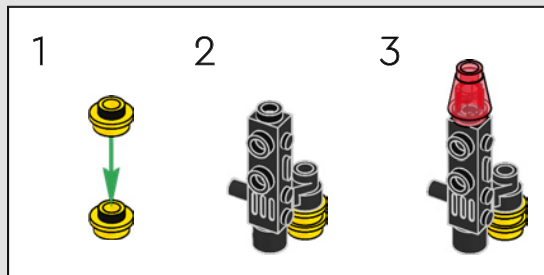

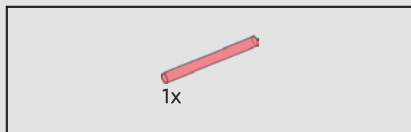

32

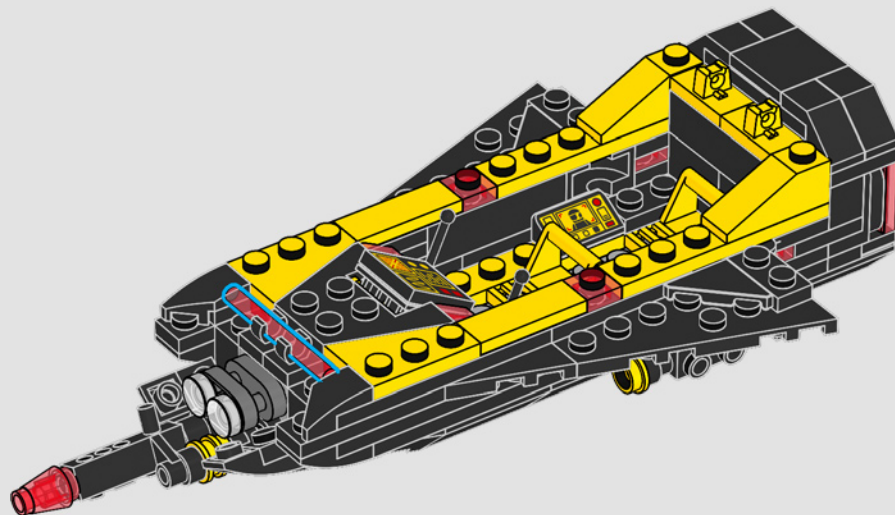

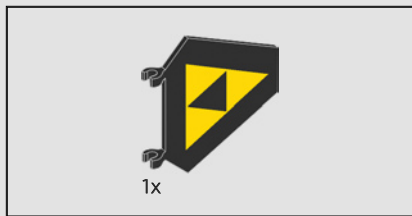

33

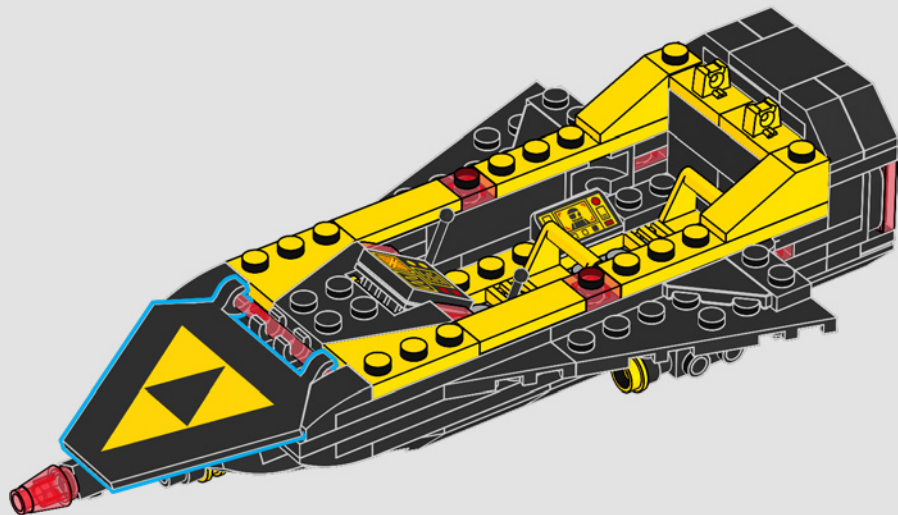

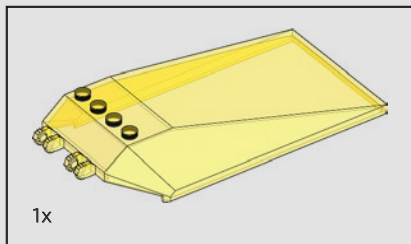

34

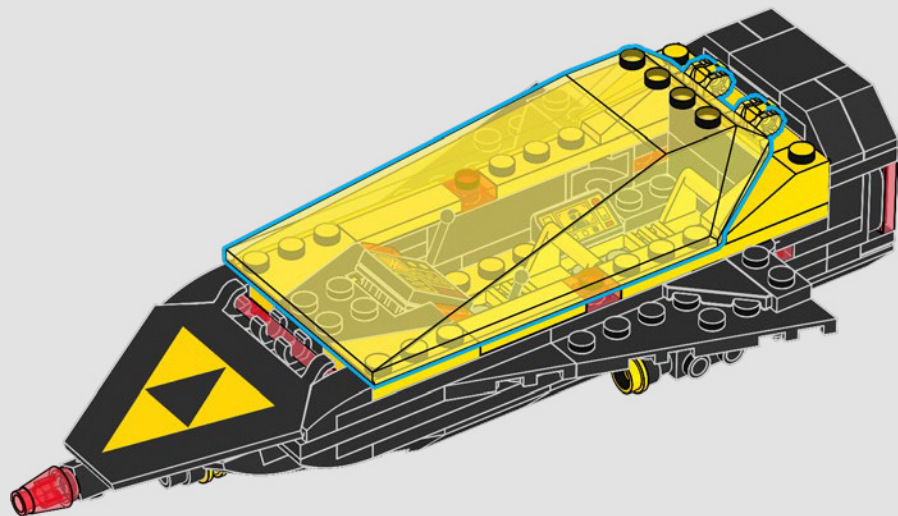



LEGO and the LEGO logo are trademarks of the LEGO Group. ©2025 The LEGO Group.